

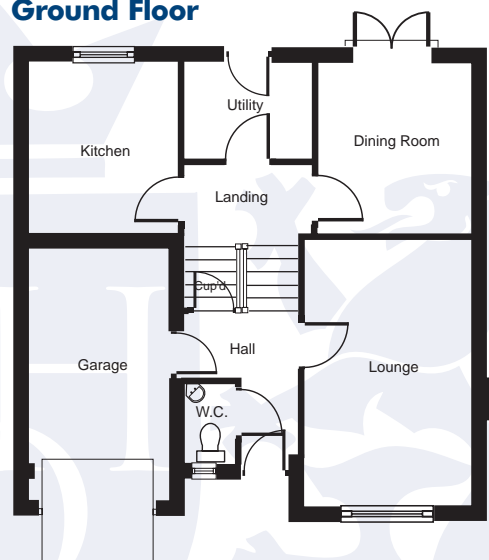

DOVEDALE - 4 BEDROOM SPLIT LEVEL DETACHED HOUSE

Ground Floor



First Floor

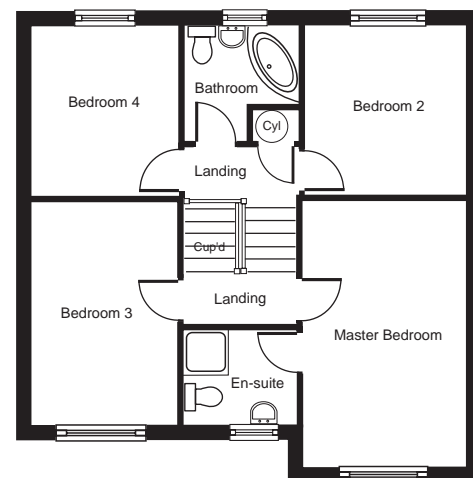

Lounge	5.00 x 3.15	16' 5" x 10' 4"
Dining Room	3.20 x 2.90	10' 6" x 9' 6"
Kitchen	3.20 x 2.70	10' 6" x 8' 10"
WC	1.55 x 1.05	5' 1" x 3' 5"
Utility	2.45 x 1.80	8' 0" x 5' 11"
Garage	4.75 x 2.70	15' 7" x 8' 10"

Master Bedroom	5.00 x 3.20	16' 5" x 10' 6"
En suite	2.20 x 1.80	7' 3" x 5' 11"
Bedroom 2	3.20 x 3.15	10' 6" x 10' 4"
Bedroom 3	4.20 x 2.80	13' 9" x 9' 2"
Bedroom 4	3.20 x 2.85	10' 6" x 9' 4"
Bathroom	2.25 x 2.15	7' 5" x 7' 0"

 **Ashmount**